

Load Cells Compression AC-A

Revisión 01 | Reviewed by JN

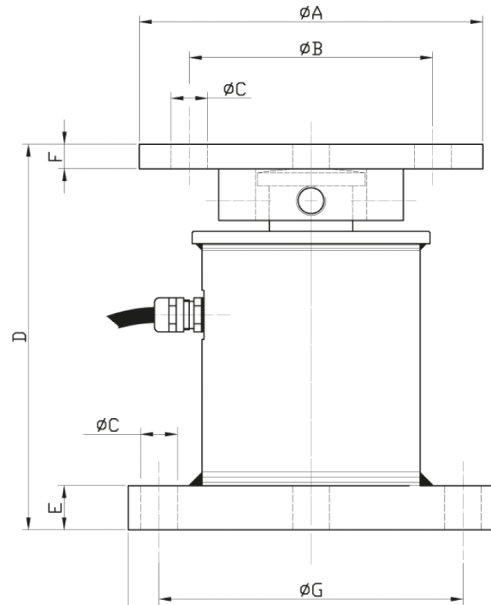

airpes®



Capacidad [t]	A	B	C	D	E	F	G	H
10-15-25-35	ø140	ø114.5	ø15x6 Tal.	157	18	10	ø124	ø149
50	ø169	ø125	ø15x6 Tal.	161	20	14	ø154	ø179
75-100	ø200	ø170	ø15x6 Tal.	195	25	25	ø172	ø200
200	ø250	ø215	ø17x8 Tal.	245	32	30.5	ø215	ø250

General information

The model AC-A load cells have been specially designed to work under compression in column.

Construction in stainless steel; 4.000 OIML- R60 divisions. Incorporates gas dischargers as a protection against electric discharges. Waterproof IP-67. Capacities from 10t till 200t.

Characteristics

Category of precision: C3, C4

Sensitivity: $2 \pm 0,1\% \text{mV/V}$

Vmin: $E_{\text{max}}/10000$

Supply voltage: $5 \div 15\text{V}$

Resistance of entry: $800 \pm 3\Omega$

Resistance of exit: $700 \pm 3\Omega$

Compensated margin of temperature: -10°C a $+40^\circ\text{C}$

Insulation resistance: $>5000\text{M}$

